

Pokini

Pokini Tab Z10B



Manual

English

Index

| | |
|---|----|
| 1. Getting Started..... | 4 |
| 1.1 Content of package..... | 4 |
| 1.2 Perspectives | 5 |
| 2. Desktop Layout | 6 |
| 2.1 Initial Desktop..... | 6 |
| 2.2 Desktop menu Instructions..... | 6 |
| 3. Installation of SIM-card and TF-card..... | 6 |
| 4. System Setting..... | 7 |
| 4.1. Network & Internet | 7 |
| 4.2. Apps & Notifications..... | 8 |
| 4.3. Battery | 8 |
| On this page you can check battery power usage, open power saving mode and make some battery settings, as shown in the following pictures | |
| 4.4. Display | 8 |
| 4.5. Sound | 8 |
| 4.6. Storage | 8 |
| 4.7. Privacy | 8 |
| 4.8. Location | 8 |
| 4.9. Security | 8 |
| 4.10. Accounts | 8 |
| 4.11. DuraSpeed | 8 |
| 4.12. System | 9 |
| 4.13. About Tablet..... | 9 |
| 5. bloated lithium-ion battery..... | 10 |
| 6. Receive help and contact EXTRA Computer..... | 11 |

1. Getting Started

1.1. Content of package

Carefully unpack your packaging and remove the items listed below. If any of the items are missing or damaged, please contact your retailer immediately:

- 1x Pokini Tab Z10B



- 1x AC-Adapter



1.2. Perspectives



| Nr. | Component | Description |
|-----|--|--|
| 1 | Power Button | Press it for one to two seconds, to power the tablet on. |
| 2 | Volume key + | Increase the audio volume. |
| 3 | Volume key - | Decrease the audio volume. |
| 4 | Barcode Scanner | Support one-dimensional code and two-dimensional code. |
| 5 | Front camera and charging Light and light sensor | 5.0MP, support photo and video. The LED indicates if the tablet battery is loading. The light sensation can adjust the brightness automatically. |
| 6 | Power button | Press to start or close the screen display. You can use this button to put the rugged phone into sleep mode, or wake up from sleep mode. |
| 7 | Scan key | Press to start the barcode scanner. |
| 8 | USB Typ C | Use this port to charge your device or connect other devices like external storage media. |
| 9 | Pogo-Pin | Used to connect the charging base, expand USB and the network port/charging interface. |

2. Desktop Layout

2.1. Initial Desktop

Slide the arrow up and go to the desktop, as below picture.

2.2. Desktop menu Instructions

This interface can start the application in a quick way, enter the menu operation, users can add shortcuts to the desktop according to their own needs, as below picture.

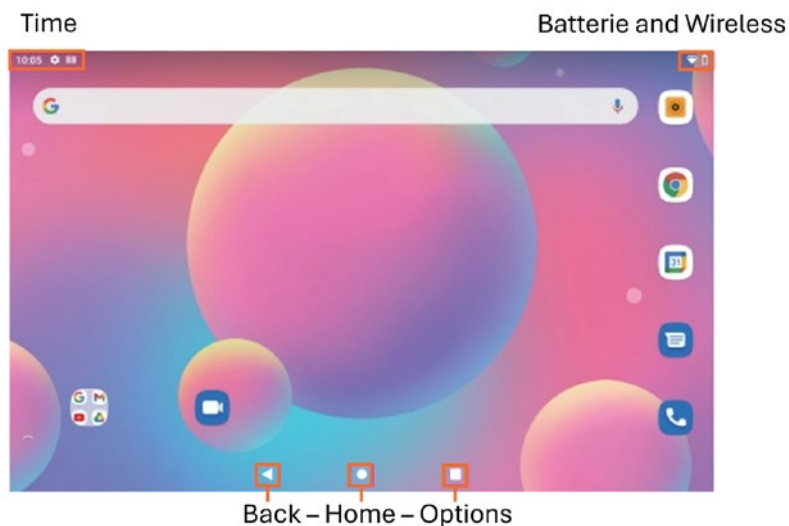

3. Installation of SIM-card and TF-card

Press the position indicated by the arrow 1 in and take out the card seat.

After taking out the card holder, you can place the Micro SIM + TF card, and then put it in the original place.

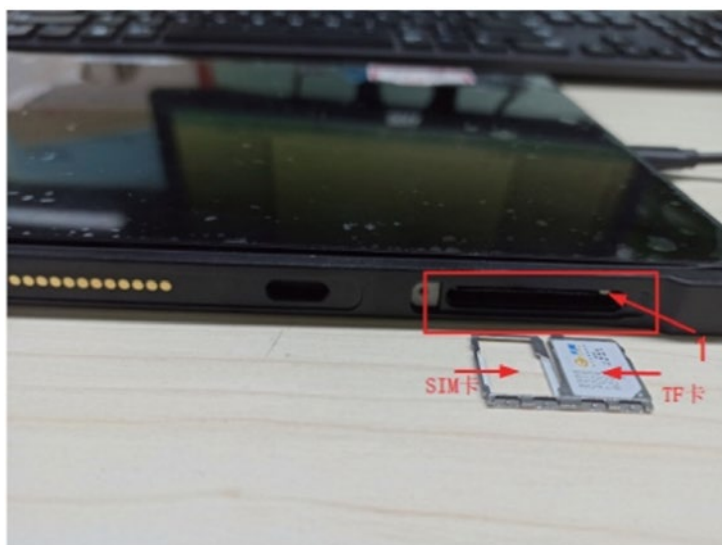

4. System Settings

Users can set related functions in the setting interface according to their needs, which is more convenient to use.

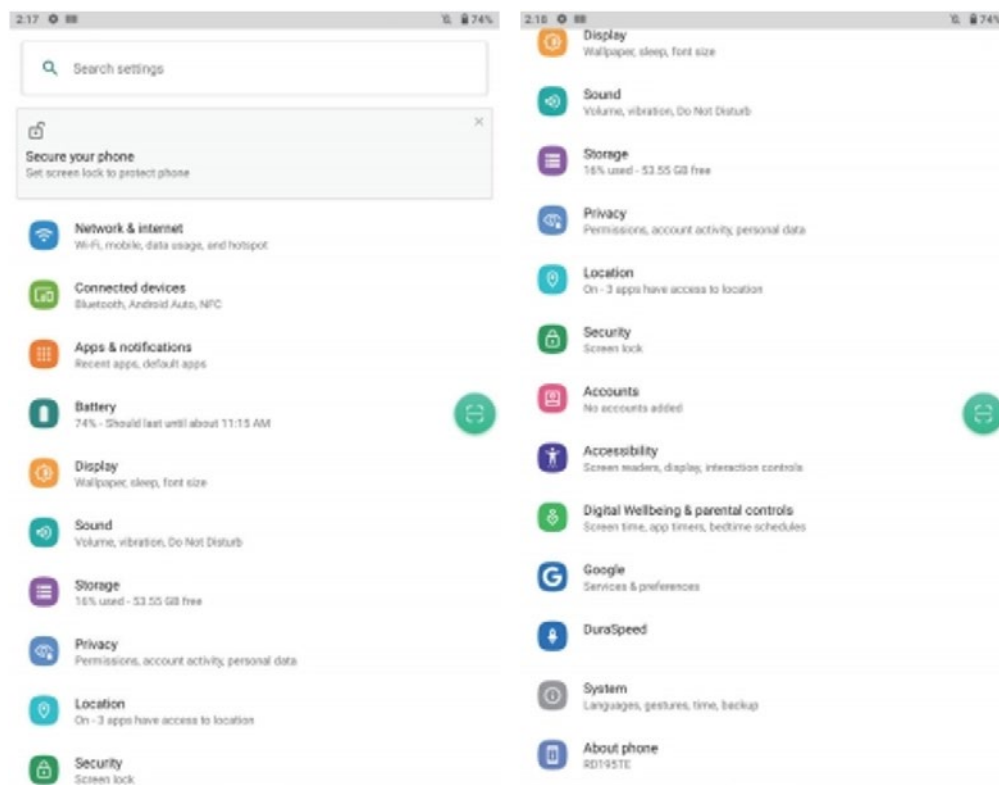

4.1. Network & Internet

In this interface, you can set WiFi, Mobile network, Airplane mode, Mobile plan, Hotspot & tethering, and Advanced, etc.

Wi-Fi

Search Wi-Fi AP, input password can be connected.

Connected devices

In this interface, you can set Bluetooth, NFC, projection, printing, Android auto, view files received by Bluetooth, etc.

Bluetooth Setting

Search this interface for Pair new device, and Connection preferences.

NFC

In this interface, you can set NFC. Allow data exchange when the phone touches an NFC device.

4.2. Apps & Notifications

View installed App storage space size, traffic usage, stop using App, set screen lock time, default notification prompt.

4.3. Battery

On this page you can check battery power usage, open power saving mode and make some battery settings, as shown in the following pictures.

4.4. Display

On this page you can set Brightness adjustment, Night light mode, wallpaper, sleep time, interactive screen saver, front size, screen rotation switch, etc.

4.5. Sound

Set media volume, alarm volume, notify volume (can also use physical keys to the corresponding interface directly to adjust, do not disturb settings) notification ringtone settings and other options.

4.6. Storage

AView system memory usage, install and uninstall SD cards.

4.7. Privacy

In this interface, you can view Permission manager, Show passwords, Notifications on lock screen, Autofill service from Google and Advanced.

4.8. Location

In this interface, you can turn on or off GPS, allow or restrict the use of an application to obtain location information.

4.9. Security

In this interface, you can set screen locking mode (none, sliding, pattern, pin code, password), device management application, encryption and credentials, fixed screen, etc.

4.10. Accounts

Other accounts (Exchange, IMAP, POP3) can be added in this interface.

4.11. DuraSpeed

DuraSpeed accelerates the speed of foreground applications by inhibiting the activities of background applications, but some notifications may not be accepted normally.

4.12. System

You can set wireless upgrade, language and input method, date and time, backup, reset options, and debugging related to developer options (enter the location of mobile phone and version number for 7 consecutive clicks).

Languages & input

Other languages can be added and switched, and virtual keyboard and physical keyboard can be set.

Date & time

You can manually set the date and time, or use the network to automatically obtain the date and time, and you can set the 24-hour display.

Gestures

You can quickly turn on the camera (press the power twice) through gesture settings. The system navigation can switch between gesture navigation and three button navigation, and vibrate when you call (press the power and volume + at the same time).

Reset options

You can reset WLAN, mobile data network and Bluetooth settings, Application preferences can be reset and factory settings can be restored.

4.13. About Tablet

View status information, device models, Android version / Android patch level, base band version (mobile network module model), kernel version, software version number, etc.

5. Bloated lithium-ion battery

The Pokini Z10B is equipped with a lithium-ion battery, which is common for most other mobile devices. External influences or potential defects in the battery can cause it to inflate.



Note: A swollen lithium-ion battery can be dangerous and should be handled with extreme care. Please follow these instructions carefully to avoid injury or damage.

Safety is our top priority: In the event of detecting swelling or unusual deformations in the battery of your Pokini FS12L, it is strongly recommended to cease using the device. Turn off the device, disconnect it from the power source, and refrain from any manipulation of the battery.

Avoiding pressure and shocks: An inflated battery is unstable and can be damaged by pressure or shocks. Prevent any external impact that could affect the battery.

Exclusion of heat sources: Keep the device and the inflated battery away from heat sources. Elevated temperatures could worsen the situation and increase the risk of fire or explosion.

No attempt to open the battery: No attempt to open the battery: It is strictly prohibited for safety reasons to open the inflated battery. This poses the risk of chemical reactions, fire hazards, or potential injuries. Repairs or maintenance should only be carried out by qualified personnel.

Disposal: An inflated battery must never be disposed of in household waste. It is advisable to contact local authorities or appropriate collection points to dispose of the battery in accordance with applicable hazardous waste guidelines.

Seeking professional assistance: We strongly recommend seeking professional help in cases of an inflated battery to ensure safe disposal or replacement. Contact the manufacturer or authorized service centers for further instructions.

Minimizing damage: If the inflated battery leaks fluids or is damaged, avoid any contact with the skin or eyes. Thoroughly wash hands after touching such substances and seek medical assistance if necessary.

Preventive measures: To reduce the risk of an inflated battery, avoid extreme temperatures and excessive stress that could affect the battery.

Continuous monitoring: Regularly monitor the condition of your batteries. If there are signs of deformation, overheating, abnormal behaviour, or unusually short battery life, we recommend consulting the manufacturer or an authorized service partner.

6. Receive help and contact EXTRA Computer

6.1. Contact EXTRA Computer

For any inquiries regarding sales, technical support or customer service at EXTRA Computer, comprehensive information is available. You can find them at:

<https://www.extracomputer.de/service/service-center/>

Your direct contact to the EXTRA support team

Mail: support@extracomputer.de

Phone: 07322 96 15 – 400

Your direct contact to the EXTRA service team

Mail: service@extracomputer.de

Phone: 07322 96 15 – 440



CE mark. It declares compliance with all applicable European Union (EU) directives. For questions about the CE marking:

EXTRA Computer GmbH,
Brühlstraße 12,
89537 Giengen-Sachsenhausen



In the European Union, this symbol indicates that this product, including the battery, should not be disposed of with other household waste. It is your responsibility to take it to a designated collection point for the recycling of waste electrical and electronic equipment. For further information, please contact your local waste collection point or the place of purchase of this product.

Support

You have any technical questions?

If you have problems or questions, please contact us by e-mail:

support@pokini.de

V1.1 / 10-2024

EXTRA Computer GmbH
Brühlstr. 12
89537 Giengen-Sachsenhausen
Deutschland / Germany

all rights reserved

www.pokini.de